

Teacher Tote Bag



For the teacher on-the-go, this tote is designed for convenience. The outside pockets keep pens and other small items handy, and the inside pocket keeps things like a phone within quick reach. All the items needed to make the tote are cut out using your crafting machine and then assembled using your sewing machine. The finished size of this durable, canvas tote is approximately 8½" x 6" x 4" (22cm x 15cm x 10cm).

What you need

- Canvas Fabric for Outer Bag - 24" x 48" (65cm x 125cm)
- Cotton Fabric for Lining - 24" x 48" (65cm x 125cm)
- Heavy Weight Fusible Interfacing
- Leather or Faux Leather in different colors
- Permanent Vinyl, White
- Fabric Grip Mat 24" x 24"
- Standard Grip Mat 12" x 12"
- Rotary Blade

- Basic Blade
- Washable Fabric Pen
- Brayer
- Scraper
- Weeding Tool
- Painter's Tape
- Iron and Ironing board
- Sewing Machine
- All Purpose Thread
- 90/14 Universal Needle
- Transfer Tape
- Sewing Clips or Pins
- Snap Fastener 5/8" (15mm)
- 2 D-rings - Size 1½" (38mm)
- Adjustable Shoulder Strap

Directions

1. Cut your fabrics to fit the 24" x 24" mat. You will need two pieces each of the bag's outside fabric, the lining fabric and the fusible interfacing.
2. Open the project in Canvas. Select the "Name" layer. In the Lettering menu, type the name of your choice. Adjust the size if necessary.

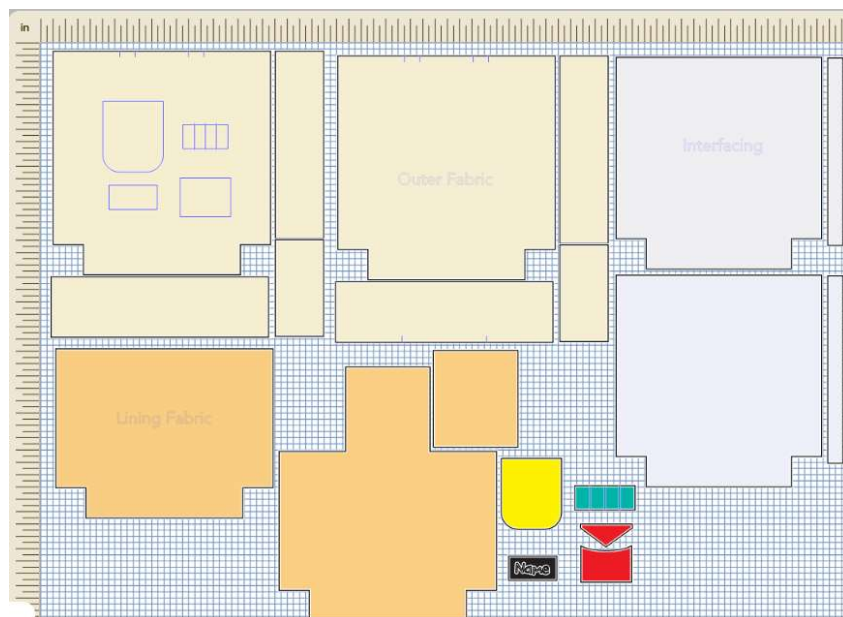

3. Go to the Output Menu and press Send to Machine. Place the canvas fabric on your Fabric Grip Mat. Use a Brayer to help adhere the fabric to the cutting mat, eliminating any wrinkles or bubbles. Follow the steps to draw and cut the fabric on your crafting machine.

Note: When using more than one material, check all settings and customize inputs for your mat size, material type, material size, and arrangement of pieces before selecting next to begin cutting each layer.

Before you cut each design, make a test cut to determine the proper pressure and speed needed to cut through each material.

4. Then cut the bag lining and the fusible interfacing. Use the Brayer to help smooth out your fabric on the mat before cutting to help ensure a smooth even cut of your material.
5. Place the leather or faux leather on your Standard Grip Mat. Tape the sides down using painter's tape. Follow the steps to cut the material on your crafting machine.

Note: Before you cut each design, make a test cut to determine the proper pressure and speed needed to cut through each material.

6. Place the permanent vinyl on your Standard Grip Mat. Follow the steps to cut the vinyl on your crafting machine. Weed the vinyl and set aside for now.
7. Follow the manufacturer's instructions to apply the fusible interfacing to wrong side of the bag outer fabric, front and back pieces, using an iron or a Heat Press.
8. Prepare the Handles: Fold the handle pieces in half lengthwise, right side out, and press. Place the interfacing inside, lining up the fold, fuse in place. Fold the long sides raw edges towards the center, using the interfacing as a guide and press.

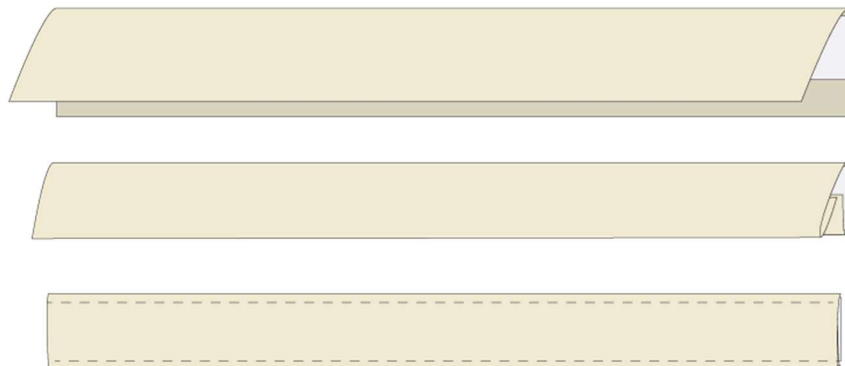

9. Set your sewing machine for straight stitch, with a stitch length of about 3mm. Topstitch along each side of the strips.

10. Prepare the Shoulder Strap Loops: Fold the fabric rectangles in half lengthwise and press. Fold the raw edges towards the center and press again. Topstitch along the edges.

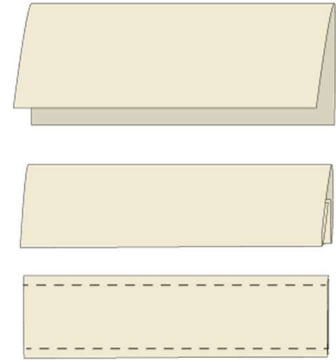

11. Sew the Lining and Inner Pocket: Pin the inner pocket to the bag's facing at the pen markings, right sides together. Sew using $\frac{1}{2}$ " (12mm) seam allowance. Press the seam allowances towards the pocket.



12. Place the lining piece with pocket on top, right sides facing. Stitch along the facing and pocket using $\frac{1}{2}$ " (12mm) seam allowance. Press the lining down.

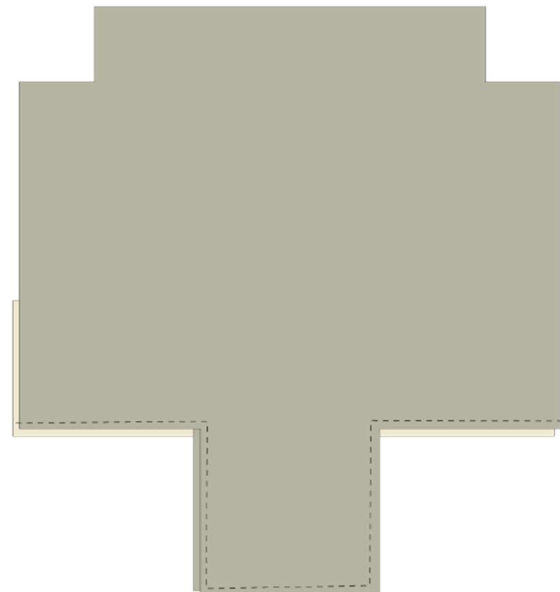

13. Pin the second lining piece to the other interfacing piece and sew together.

14. Place the lining pieces, right sides together and stitch along the sides and bottom. Leave an opening on one side to turn the right side out later.

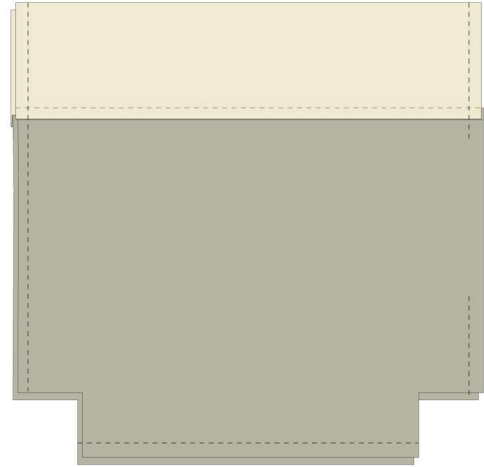

15. Fold the corners and stitch across on both sides.

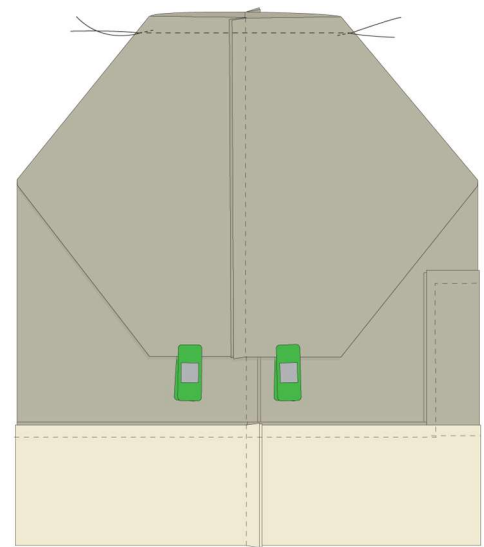

16. Sew the pockets and penholder to the bag front: Start by applying the snap fastener to the envelope pocket.

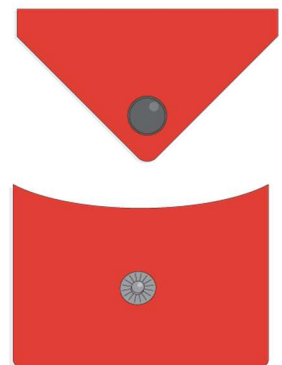

17. Place the pockets on the bag front at the markings. Use tape to hold the pieces in place while sewing. Use matching thread to each pocket and name tag. Backstitch at the beginning and end of each seam to secure.

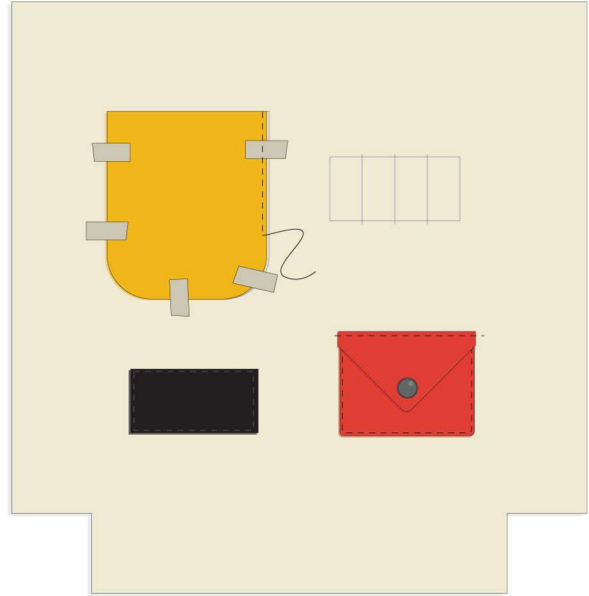

18. Pen Holder: Place the left edge along the left pen mark and stitch close to the edge. Line up the next lines and stitch down. Continue sewing the other three vertical seams.

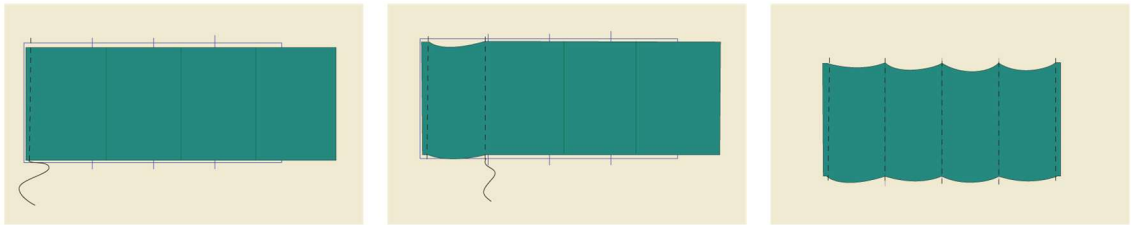

19. Place the bag outer fabric pieces right sides together and sew the bottom seam. Reinforce the bottom seam by folding the seam allowance to one side and make two rows of topstitching.

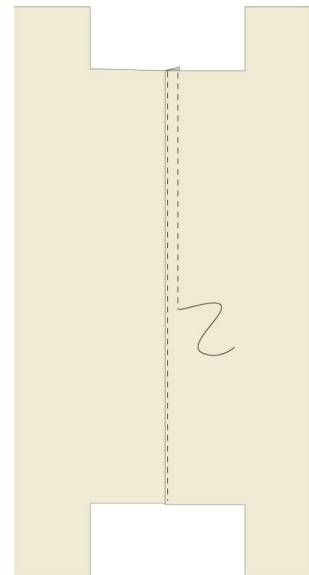

20. Sew the side seams then fold the bottom corners and stitch across. Turn the right side out.

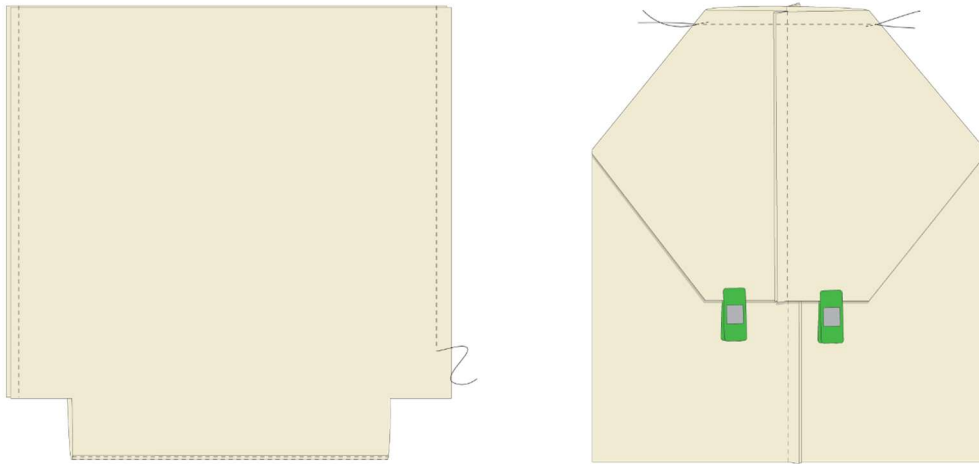

21. Insert the D-rings to the shoulder strap loops and fold in half. Pin or clip to each side of the outer bag. Pin the handles at the marks. Sew the handles and shoulder strap loops in place.



22. Insert the outer bag into the lining with the right sides together. Stitch along the top using $\frac{1}{2}$ " (12mm) seam allowance. Through the opening in the lining, turn the right side out. Sew the opening in the lining closed.

23. Press the top edge of the bag and sew a seam 1" (2.5cm) from the edge.

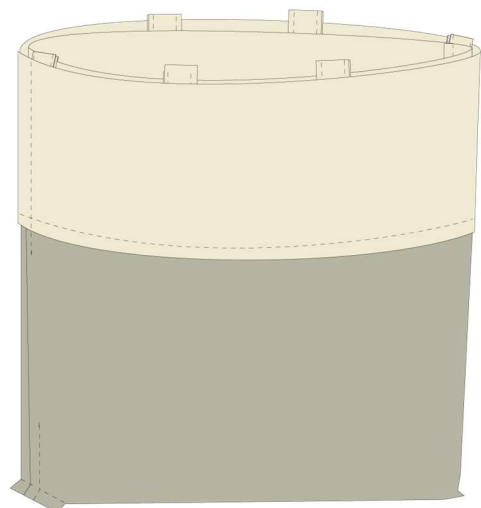

24. Cut pieces of Transfer Tape slightly larger than the vinyl name sign. Peel off the backing paper from the Transfer Tape and place it over the vinyl design. Use the Scraper Tool to burnish it into the vinyl. Peel the vinyl liner away from the tape and the design, making sure all vinyl is transferred to the Transfer Tape.
25. Place the vinyl designs on the black nametag placket and use a Scraper Tool to apply the vinyl. Gently peel off the Transfer Tape.
26. Attach the shoulder strap to the bag.

